

DRAFT

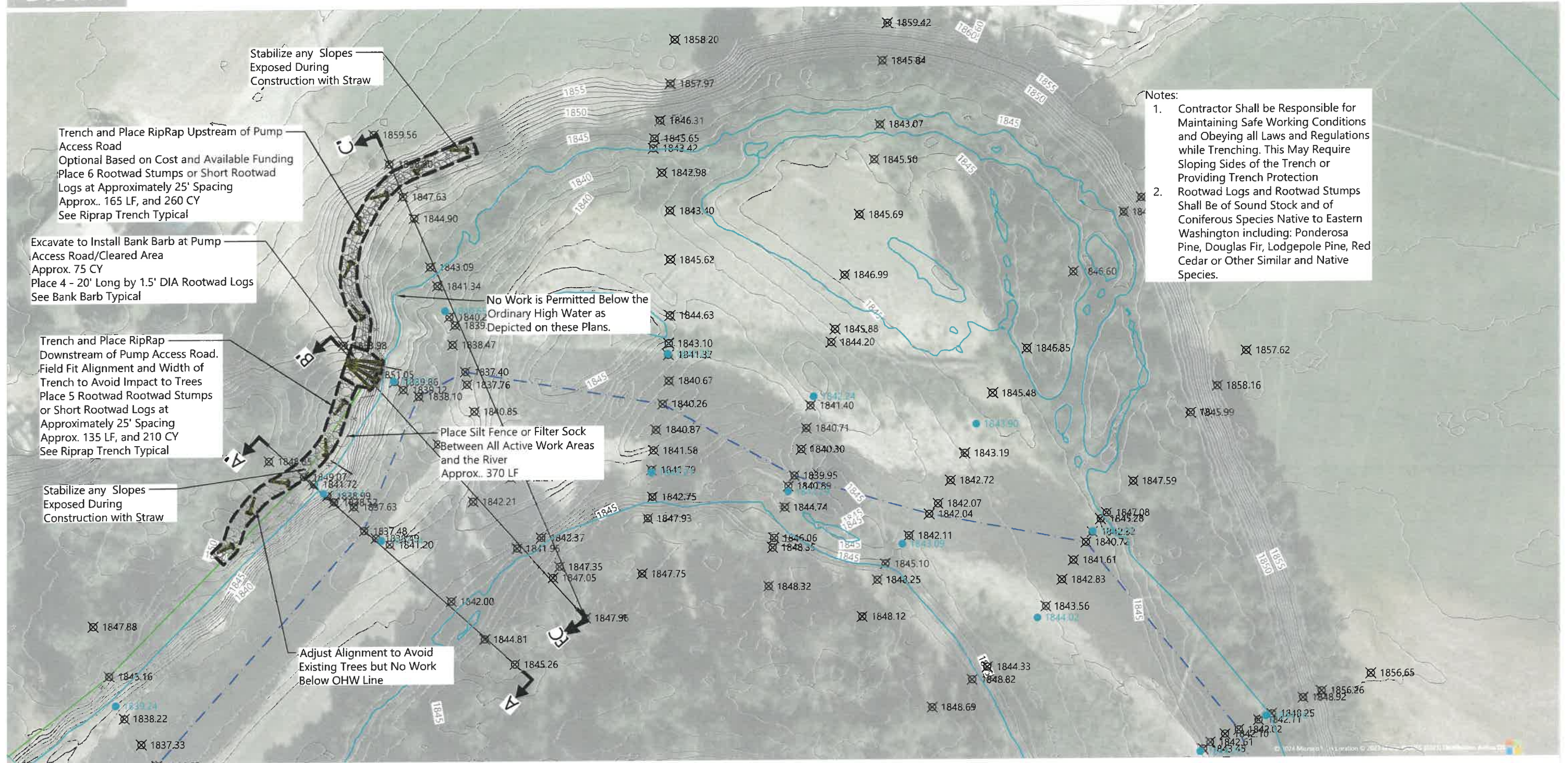

SOURCE: 2023 HLA Survey and 2017LiDAR. Aerial by Bing Maps.
HORIZONTAL DATUM: Washington State Plane, South Zone, NAD83, U.S. Survey Feet
VERTICAL DATUM: NAVD88

LEGEND:

- Existing Contours (1' & 5' Intervals)
- 2023 Survey Point
- Ordinary High Water (OHW)
- Approximate Thalweg
- Proposed Trench and Riprap Fill Areas
- Silt Fence or Filter Sock

RECEIVED
AUG 16 2024

Kittitas County CDS

Printed: Date: 5:00 PM | User: mgieschen
Filepath: I:\Projects\0676-Kittitas County Conservation District\Maggs Property Bank Protection Conceptual Design\0676-RP-001 Maggs Property Design.dwg Figure 1



Figure 1
Proposed Bank Protection Trench: Site Plan
Maggs Property

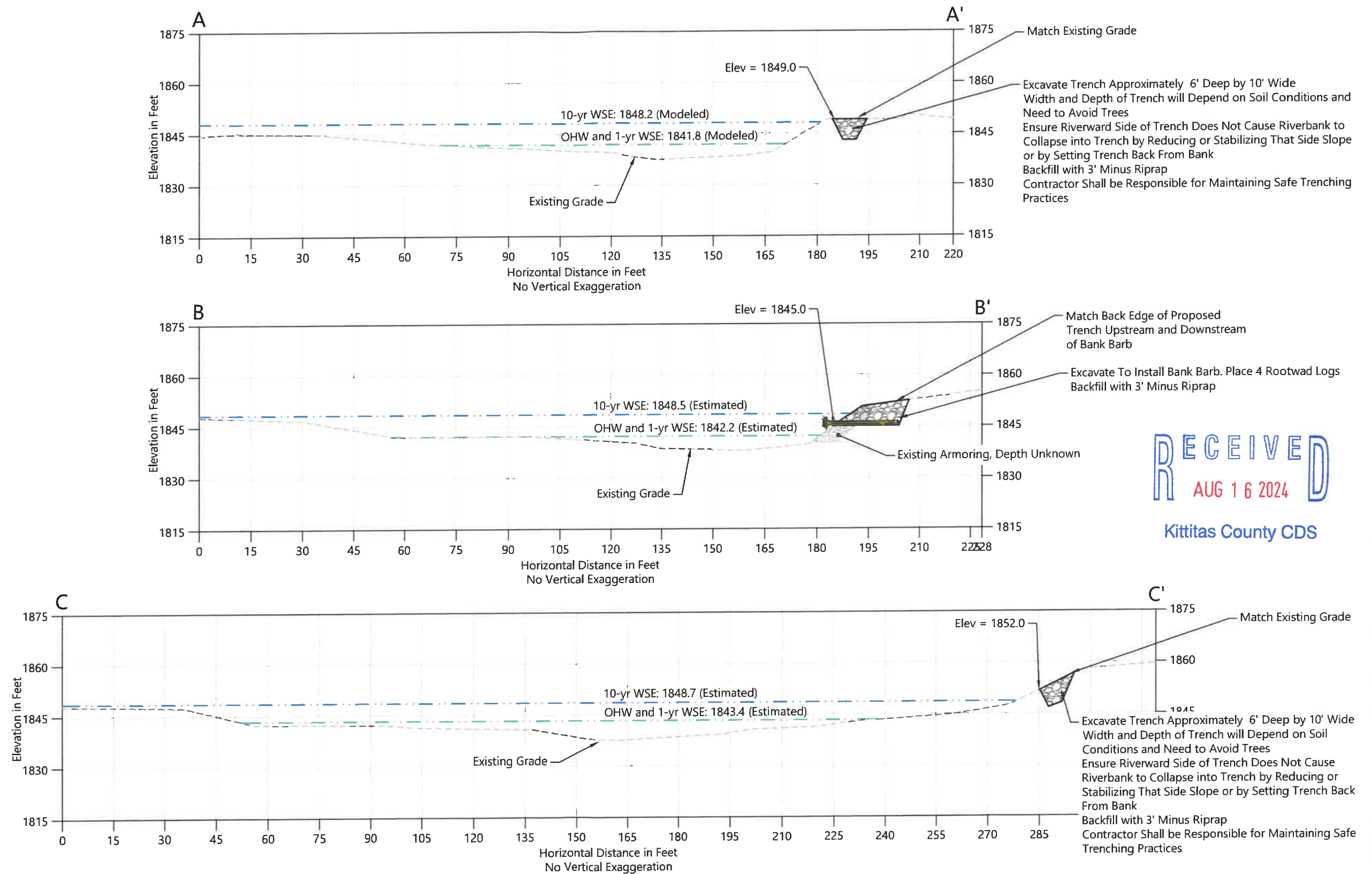

RECEIVED
AUG 16 2024
Kittitas County CDS

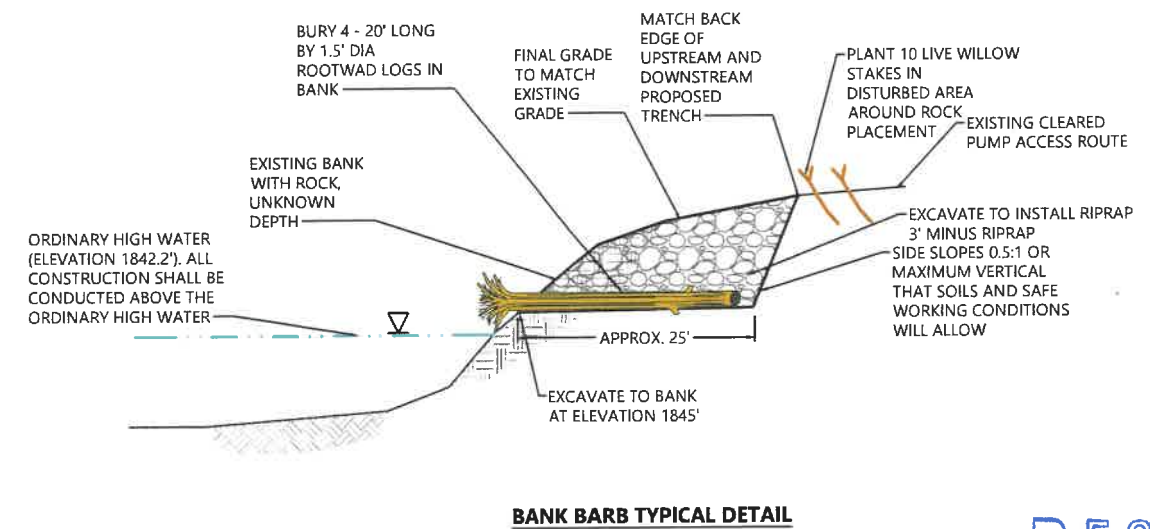
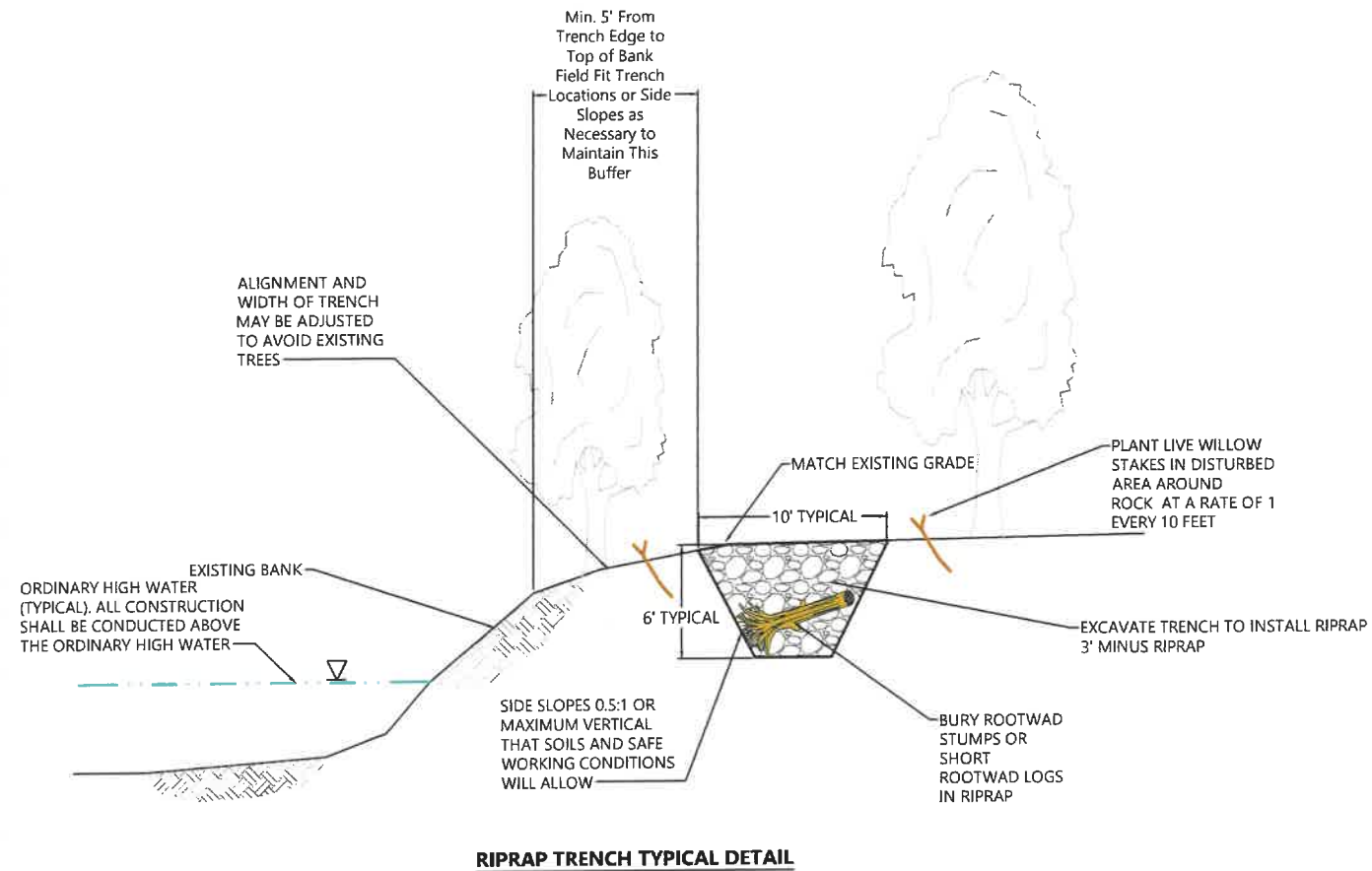

Notes for All Typical Sections:

1. Contractor Shall be Responsible for Maintaining Safe Working Conditions and Obeying all Laws and Regulations while Trenching. This May Require Sloping Sides of the Trench or Providing Trench Protection
2. Rootwad Logs and Rootwad Stumps Shall Be of Sound Stock and of Coniferous Species Native to Eastern Washington including: Ponderosa Pine, Douglas Fir, Lodgepole Pine, Red Cedar or Other Similar and Native Species.

RECEIVED
AUG 16 2024

Kittitas County CDS